

**Tax Payment Available**

Pay Taxes

**Property Information**

<b>Property ID</b>	430-58016-0-0000	<b>Property Use</b>	100 - RESIDENTIAL
<b>Tax Year</b>	2026 ▼	<b>Land Use</b>	113 - SINGLE FAMILY DWELLING
<b>Township</b>	430 Martic Twp	<b>Tax Status</b>	Taxable
<b>Site Address</b>	364 STEINMAN FARM RD	<b>Clean &amp; Green</b>	No

**Property Sketches & Photos**

1-1

Imported Image

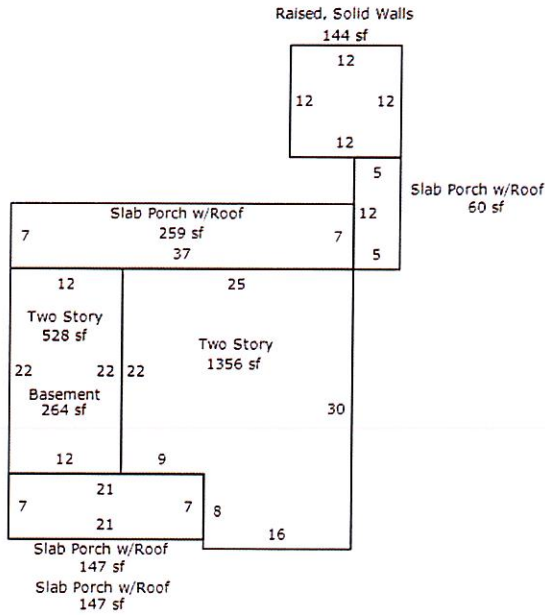

Related Names

**Parcel Owner** MARTIC TOWNSHIP,  
370 STEINMAN FARM RD  
PEQUEA, PA 17565  
**Status** Current

Assessments

Annual Billing

	Land	Building	Total	Pref. Land	Pref. Building	Pref. Total
Non-Exempt	54,400	114,600	<b>169,000</b>	0	0	<b>0</b>
Exempt	0	0	<b>0</b>	0	0	<b>0</b>
<b>Total</b>	<b>54,400</b>	<b>114,600</b>	<b>169,000</b>	<b>0</b>	<b>0</b>	<b>0</b>

**Note:** Preferential assessment values are used for taxation when preferential values are greater than zero.

Property Characteristics

Electric	Gas	Sewage	Water
HOOKED-UP	NONE	SEPTIC	WELL

Market Land Valuation

Property Type	Land Type	Sq. Ft.	Calc. Acres
RES - Residential	2 - PRIMARY HOMESITE	24,829	0.5700

Structure 1 of 2

Property Type	Description		Style	Total Living Area	Year Built
RES - Residential	Residence		Two Story	1,884	1892
<b>Accommodations</b>			<b>Basement</b>		
Extra Fixtures		2	Total Basement Area	264.00 Sq.Ft.	
Full Baths		1			
Masonry Trim		No	<b>Exterior Walls</b>		
Number of Bedrooms		4	Frame, Siding, Metal	1884.00 Sq.Ft.	
Number of Families		1			
Number of Rooms		7	<b>Fuel Type</b>		
Permanent Stairs		Yes	Fuel Type	Electric	
<b>Porches, Decks, Breezeways</b>			<b>Heating/Cooling</b>		
Raised Enclosed Porch, Solid Walls	144.00 Sq.Ft.		Warmed & Cooled Air	1884.00 Sq.Ft.	
Slab Porch with Roof	613.00 Sq.Ft.		<b>Roofing</b>		
			Metal, Preformed	1884.00 Sq.Ft.	
<b>Story Height</b>			<b>Solar Panels</b>		
Number of Stories	2.00		Solar Panels	No	
			<b>Style</b>		
			Style	FARM-HOUSE	

Structure 2 of 2

Property Type	Description	Style	Total Living Area	Year Built
RES - Residential	Detached Structure #1	Outbuildings	380	1975
<b>Garages</b>				
030 - Frame Garage	380.00 Square Ft.			

Exemptions

Exemption Type	Status	Farmstead
Homestead	Application Denied	No

Sales History

Year	Document #	Sale Type	Sale Date	Sold By	Sold To	Price
2012	5991381		4/13/2012	TYLER TURNER	MARTIC TOWNSHIP	\$140,000

**Note:** You can use the Recorder of Deeds site to search deeds by document number.

Billing

**NOT A CERTIFIED COPY - FOR INFORMATIONAL PURPOSES ONLY**

Billing Pd.	Tax Billed	Discount/Pen.	Total Billed	Total Paid	Balance Due	Date Paid
January	\$627.16	(\$12.54)	\$614.62	\$0.00	\$614.62	

**Note:** Payment amounts may only reflect the Lancaster County amounts

Tax Amounts - January - Billing Number: 2026430001331

Fund Desc.	Rate Type	Tax Rate	2% Discount if paid by 4/30/2026	Base Tax if paid by 6/30/2026	10% Penalty if paid after 6/30/2026
Martic Twp	Millage	0.51000000	\$84.47	\$86.19	\$94.81
Lancaster County	Millage	3.20100000	\$530.15	\$540.97	\$595.07
<b>Total</b>			<b>\$614.62</b>	<b>\$627.16</b>	<b>\$689.88</b>

Contact Information

Mail current year, county & municipal real estate tax payments to...

Lancaster County Treasurer  
 County & Municipal Tax Bill  
 P.O. Box 3894  
 LANCASTER, PA 17604  
 (717) 299-8222

Tax certification **OVERNIGHT** requests can be sent to...

Lancaster County Treasurer  
 150 North Queen Street, Suite 122  
 Lancaster, PA 17603

Regular Mail

Lancaster County Treasurer  
 P.O. Box 1447  
 Lancaster, PA 17608

No Delinquent Taxes